

# FORM AND FIBER | TECHNICAL SHEET

## BOX SERIES FUSED PLANTERS - CORTEN STEEL

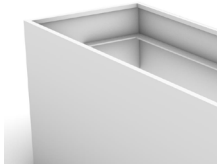

STANDARD LIP

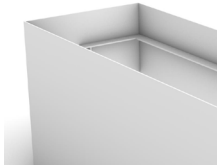

BLADE EDGE

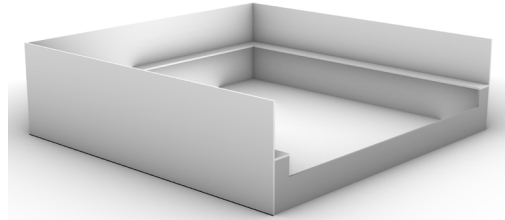

FUSED BOX SHOWING SHARED  
INTERNAL LOWERED WALL FOR CONNECTION

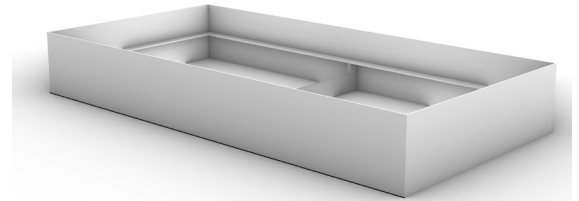

FUSED BOX SHOWING CONNECTED PORTIONS  
WITH INTERNAL LOWERED WALLS

### CONSTRUCTION

- The Box Series Corten Steel Planters are constructed of ASTM A606 Type 4 & A588 grade Corten Steel. Planters are fabricated using 14 ga., 12 ga., 10 ga., and 1/4" thicknesses. Planters are offered in two finish options:
  - Un-weathered; no exterior sealant
  - Pre-weathered with exterior sealant
- Oversized boxes are constructed with internal reinforcement comprised of horizontal stiffeners, and vertical gussets. Specific dimensions for spacing of internal reinforcement is submitted via shop drawing for approval, prior to construction.
- Planters are manufactured with standard 1", 1.5", or 2" drain holes or no drain holes. Quantity and placement as directed by Purchaser. Holes are cut to nominal O.D. for standard PVC pipe trade sizes.
- If a boxes with internally raised bases are specified, heat signatures may read through powder coat finish due to material thickness.

### PRE-WEATHERED FINISH

- Planters do not weather with consistent color and patina among groups. Units weather at varying rates and develop coloration which is unique to each individual unit. (Standard level of finish shown)
- Standard sealant is a light metal sealant with matte finish applied to exterior and is a temporary sealant for handling. Units will continue to oxidize, patina will darken and sealant will wear off.
- Purchasers should exercise caution in placement as units may leach onto adjacent surfaces until fully weathered and self sealed.



### STANDARDS

- Standard lip for 14 ga & 12 ga thick boxes = 1" wide lip + 3/4" return  
 Standard lip for 10 ga thick boxes = 1-1/2" wide lip + 3/4" return  
 Standard lip for 1/4" thick boxes = 2" wide lip with no return

### CUSTOMIZATION

- Fabrication of F&F Box Series Fused Corten planters can be customized to designer specified sizes for L X W X H. Boxes will be priced on labor, material, and thickness.

### INCLUSIONS & EXCLUSIONS

- Form and Fiber PROVIDES connecting hardware for interior connecting sections of fused boxes.
- Form and Fiber DOES NOT PROVIDE waterproofing gaskets, caulking or sealant for section connections.

### OPTIONS

- The following options are available in the fabrication of F&F Box Series Fused Corten planters. Additional charges may apply:

- |                                     |                     |
|-------------------------------------|---------------------|
| _____ Standard lip                  | _____ Blade edge    |
| _____ Flat base                     | _____ Toe-kick base |
| _____ Internally raised base        |                     |
| _____ Stainless steel leveling feet |                     |
| _____ Glides                        |                     |
| _____ Industrial casters            |                     |

