

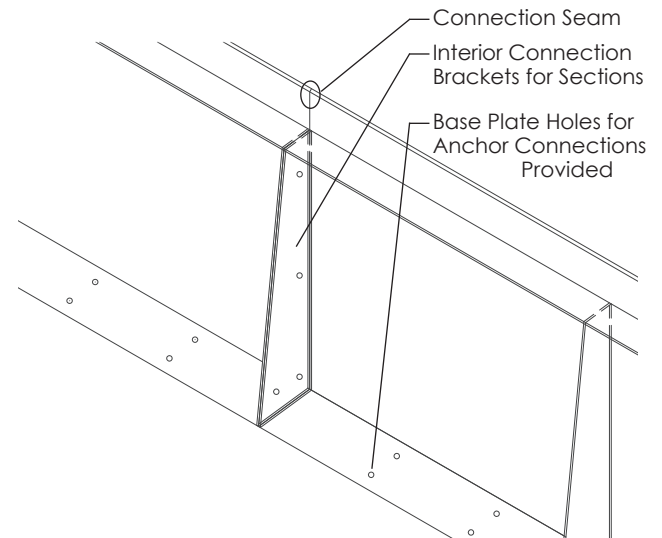

Typical Pre-Weathered Finish for Cor-Ten Steel

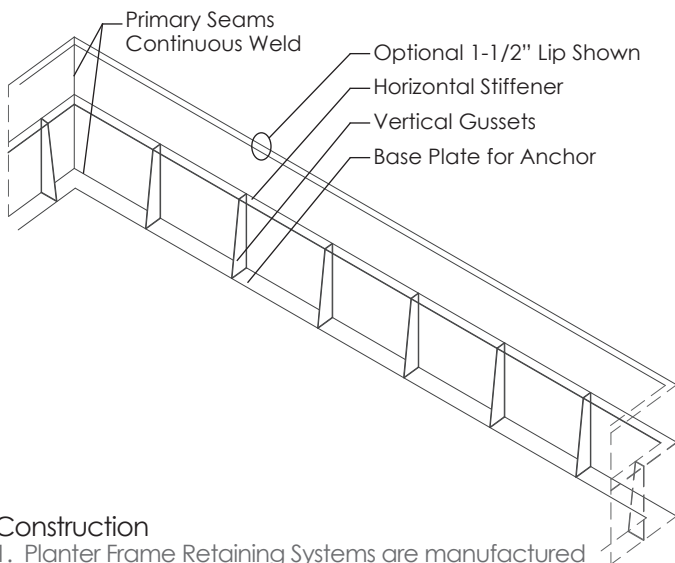

Construction

1. Planter Frame Retaining Systems are manufactured in Carbon Steel, Corten Steel, and Aluminum alloys. Thicknesses range from 1/4" to 1/2", and based on designer specification, and/or manufacturer recommendation for size and length of run.
2. Planters frame systems are constructed with horizontal stiffeners, vertical gussets, and base plates for anchor. Specific dimensions for spacing of internal reinforcement depends on frame size proposed and is submitted via shop drawing for approval, prior to construction.
3. Depending on final size and configuration, frame systems may be "sectioned" with internal brackets for on-site assembly and connection. Size of sections can range from 72"-144" in length or longer, depending on overall design configuration.
4. OPTIONAL: Frame Systems can be manufactured with or without a 1-1/2" lip.

Provided

1. Form and Fiber provides connecting hardware for interior brackets connecting sections.
2. Form and Fiber provides pre-drilled holes in base plate for contractor to anchor to sub base.

Not Provided

1. Form and Fiber DOES NOT PROVIDE anchoring hardware for connection of base plate to sub base.
2. Form and Fiber DOES NOT PROVIDE waterproofing caulking or sealant for section connections.

Waterproofing

1. All primary seams are continuously welded and Form and Fiber will apply sealant to these welded areas only. These areas will be waterproof in their construction.
2. At the discretion of the installing contractor, and as a suggestion only made by Form and Fiber, waterproofing caulking may be applied between internal connecting brackets and/or along connection seams.
3. Form and Fiber makes no recommendations for specific product used, nor is responsible for method of application, resulting aesthetic, and/or success of such waterproofing methods applied by installing contractor.
4. Form and Fiber does not warranty waterproofing applications by installing contractor.